



Grade 1, multi-point locks

LM9300 three-point lock

Overview

The LM9300 lock provides a three-point locking system designed for tornado, hurricane, fire rated, or high security applications. Latches at the top, side and bottom of the door provide protection from high wind speeds and 15-lb. projectile impacts up to 100 mph when paired with a Steelcraft Paladin tornado-resistant door.

All three latches engage when the door is shut and retract simply by rotating the lever, providing superior protection with familiar operation. Available in six functions and with 33 lever designs, the LM9300 can easily integrate into any application and suite with other Schlage® locks, as well as Von Duprin® exit devices.

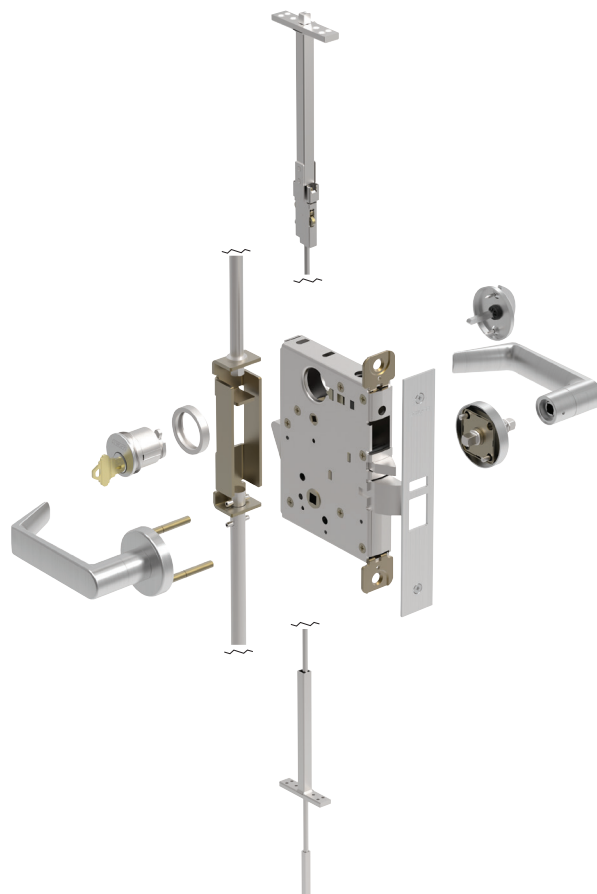

Finishes



605
Bright Brass

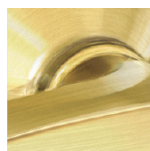

606
Satin Brass

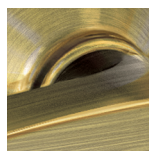

609
Antique Brass



612¹
Satin Bronze



613¹
Oil Rubbed
Bronze

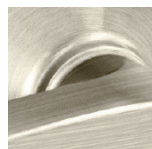

619
Satin Nickel

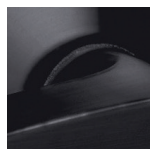

622
Matte Black



625
Bright Chrome

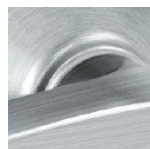

626
Satin Chrome

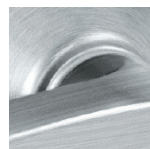

626AM
Satin Chrome,
Antimicrobial



629²
Bright Stainless



630²
Satin Stainless

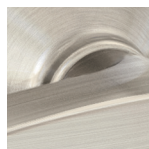

630AM²
Satin Stainless,
Antimicrobial

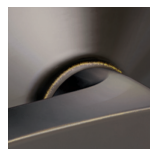

643e
Aged Bronze

¹ Available on standard levers only, not available on M Collection, Latitude, Longitude, Accent, Asti, or Merano

² Not available on Accent, Asti, or Merano



Grade 1, multi-point locks
LM9300 three-point lock

M Collection decorative lever styles^{1,3}



M51
851 - Knurled tactile warning
■ Handed



M52
852 - Knurled tactile warning
■ Handed



M53
■ Handed



M54
■ Handed



M55
■ Handed



M56
■ Handed



M57²
■ Handed



M61
■ Handed



M62²
■ Handed



M63
■ Handed

Dimensions

Lever	Width	Projection
M51	4.5"	3.2"
M52	4.5"	3"
M53	4.35"	3.2"
M54	4.35"	2.75"
M55	4.3"	3"
M56	4.6"	3"
M57	4.5"	2.9"
M61	4.5"	3.2"
M62	4.5"	2.7"
M63	4.5"	3.2"

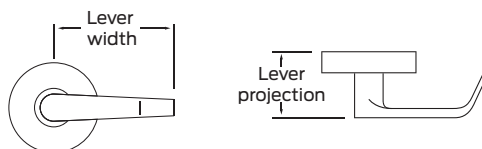

¹ M Collection not available in 612 and 613 finishes.

² Available in 629, 630, and 630AM only.

³ You must specify handing when ordering any LM9300 lock.



M Collection decorative lever styles^{1,2}



M81
881 - Knurled tactile warning
■ Handed



M82
■ Handed



M83
■ Handed



M84
■ Handed



M85
■ Handed



ME1
8ME1 - Milled tactile warning
■ Handed



ME2
8ME2 - Milled tactile warning
■ Handed



ME3
8ME3 - Milled tactile warning
■ Handed

Dimensions

Lever	Width	Projection
M81	4.8"	2.9"
M82	4.8"	2.9"
M83	4.6"	2.9"
M84	5.1"	3"
M85	4.9"	3.3"
ME1	5.5"	3"
ME2	5.2"	2.8"
ME3	5.1"	3.2"

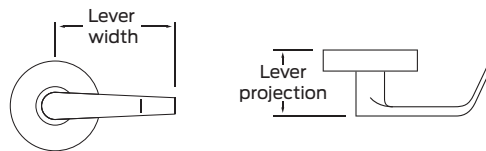

Return to door meets 1/2" requirement for all levers shown on this page.

¹ M Collection not available in 612 and 613 finishes.

² You must specify handing when ordering any LM9300 lock.

Note: ME1, ME2 and ME3 ergonomic levers designed with Gensler as product design consultant.



Standard lever styles¹



01
801 - Milled tactile warning
■ Handed



02
802 - Knurled tactile warning
■ Handed



03
803 - Knurled tactile warning
■ Handed



05
805 - Milled tactile warning
■ Handed



06
806 - Milled tactile warning
■ Handed



07
807 - Milled tactile warning
■ Handed



12
812 - Milled tactile warning
■ Handed



17
817 - Milled tactile warning
■ Handed



18
818 - Milled tactile warning
■ Handed

Dimensions

Lever	Width	Projection
01	3.875"	2.688"
02	4.75"	2.813"
03	4.75"	2.813"
05	3.75"	2.875"
06	4.625"	2.5"
07	4.625"	2.875"
12	4.625"	3.063"
17	4.75"	3"
18	4.875"	2.688"

Return to door meets 1/2" requirement for 03, 06 and 17 levers.

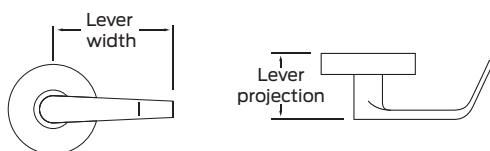

¹ You must specify handing when ordering any LM9300 lock.



Grade 1, multi-point locks
LM9300 three-point lock

Standard lever styles³



Accent (ACC)¹
■ Handed



Asti (AST)¹
■ Handed



Latitude (LAT)²
■ Handed



Longitude (LON)²
■ Handed



Merano (MER)¹
■ Handed



Omega (OME)
■ Handed

Dimensions

Lever	Width	Projection
Accent (ACC)	4.125"	3.125"
Asti (AST)	4"	2.625"
Latitude (LAT)	4.75"	2.563"
Longitude (LON)	4.875"	2.563"
Merano (MER)	4"	3.125"
Omega (OME)	5.063"	3.313"

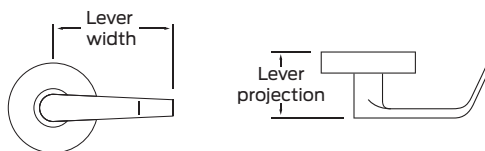

Return to door meets 1/2" requirement for Longitude and Omega levers.

¹ Not available in 612, 613, 629, or 630 finishes.

² Not available in 612 or 613 finishes.

³ You must specify handing when ordering any LM9300 lock.



Escutcheons



L full face
Specify by adding 'L' after lever design.



L concealed
Specify by adding 'C' suffix to function and by adding 'L' after lever design.



N full face
Specify by adding 'N' after lever design.

Roses



A rose
Available for use on L Series knob and lever designs. Specify by adding 'A' after lever design
Finishes: available in all L Series finishes.



B rose
Available for use on L Series knob and lever designs. Specify by adding 'B' after lever design.
Finishes: available in all L Series finishes.

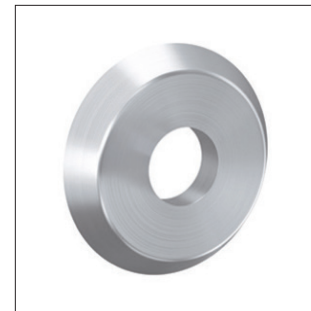

C rose
Available for use on L Series knob and lever designs. Specify by adding 'C' after lever design.
Finishes: available in all L Series finishes except 612 and 613.



AVA rose
Available for use on AST lever only. Specify as ASTAVA.
Finishes: available in all L Series finishes except 612, 613, 629, and 630.



MER rose
Available for use on MER lever only. Specify as MERMER.
Finishes: available in all L Series finishes except 612, 613, 629, and 630.

Rose	Diameter
A	2.125"
B	2.5625"
C	2.625"
AVA	2.625"
MER	2.625"

Escutcheon	Width	Height
L full face	1.75"	8"
L concealed	1.75"	8"
N full face	2.5"	7.875"

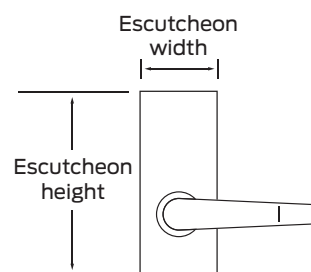



Thumbturns



Standard turn



ADA turn

Indicators

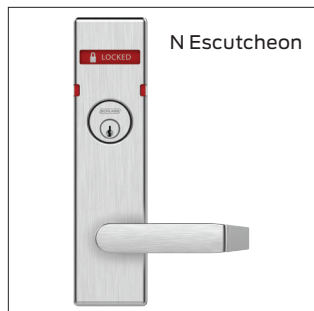

Cylinder



Thumbturn



Cointurn



Emergency key indicator

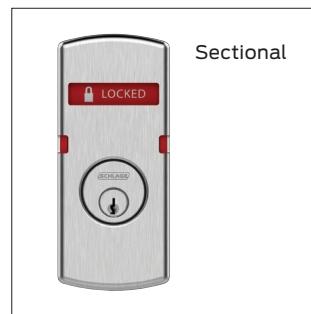

Cylinder



Thumbturn



Cointurn



Emergency key indicator

Available messages

	LOCKED	OCCUPIED	DO NOT DISTURB	
	UNLOCKED	UNOCCUPIED		
Inside trim	L283-711	L283-712	L283-713	L283-714
Outside trim	L283-721	L283-722	L283-723	L283-724



Vandgard® protection available on functions noted with an “LV” option.

Vandgard allows the outside lever to rotate freely down when locked to limit the ability of vandals to apply excessive force to the chassis helping to prevent damage to internal components.

Mechanical functions

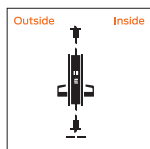

Schlage LM9310
ANSI -
Passage latch

- Latches retracted by lever from either side
- Both levers always free for immediate egress
- Auxiliary latch deadlocks latchbolt when door is closed

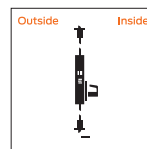

Schlage LM9325
ANSI -
Exit lock

- Latches retracted by lever from inside at all times
- Lever always free for immediate egress
- No trim on outside; not available with escutcheon trim
- Auxiliary latch deadlocks latchbolt when door is closed

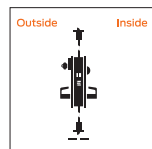

Schlage LM9350
LMV9350
ANSI -
Office and inner entry lock

- Latches retracted by lever from either side unless outside is made inoperative by key outside or by turning inside thumbturn
- Outside lever remains locked until thumbturn is returned to vertical or unlocked by key
- When locked, key and outside lever or inside lever retracts latchbolt
- Auxiliary latch deadlocks latchbolt when door is closed
- Inside lever always free for immediate egress



Optional 180 degree messaging indicator available

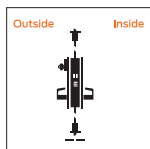

Schlage LM9370
LMV9370
ANSI -
Classroom lock

- Latches retracted by lever from either side unless outside is made inoperative by key outside
- Outside remains locked until unlocked by key
- When locked, key and outside lever or inside lever retracts latches
- Auxiliary latch deadlocks latchbolt when door is closed
- Inside lever always free for immediate egress



Optional 180 degree messaging indicator available

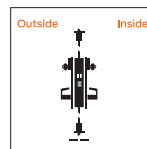

Schlage LM9371
LMV9371
ANSI -
Classroom security lock

- Latches retracted by lever from either side unless outside is made inoperative by key from either side
- When locked, key and outside lever or inside lever retracts latches
- Auxiliary latch deadlocks latchbolt when door is closed
- Inside lever always free for immediate egress



Optional 180 degree messaging indicator available



Cylinder



Lever



Thumbturn

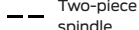

Two-piece spindle



Grade 1, multi-point locks
LM9300 three-point lock

Mechanical functions

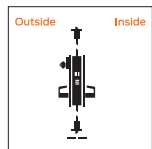

Schlage LM9380
LMV9380
ANSI -
Storeroom lock

- Latches retracted by outside lever after key is inserted and turned 280° or by inside lever
- Inside lever always free for immediate egress
- Auxiliary latch deadlocks latchbolt when door is closed



Cylinder



Lever



Thumbturn



Two-piece spindle



Cylinders

Conventional cylinder in mortise housing

P	6-pin Conventional (standard) with Schlage logo; full face mortise housing
Z	SL 7-pin Conventional (A2 pinning) with Schlage logo; full face mortise housing
L	Less cylinder and full face housing
C	Concealed mortise housing with 6-pin Conventional cylinder
W	Less concealed mortise housing and cylinder

Full size interchangeable core (FSIC) in full face mortise housing

R	6-pin FSIC with Schlage logo
M	SL 7-pin FSIC (A2 pinning) with Schlage logo
J	Less FSIC and housing
F	6-pin FSIC less Schlage logo
T	Refundable FSIC construction core

Small format interchangeable core (SFIC) in full face mortise housing

G	7-pin SFIC (A2 pinning)
B	Less SFIC and housing
BDC	Disposable SFIC construction core
H	Refundable SFIC construction core



Specifications

Chassis

Case material	CRS with zinc dichromate plating
Case size	4 ⁷ / ₁₆ " x 6 ¹ / ₁₆ " x 1" (113 mm x 154 mm x 25 mm) (chassis only)
Door thickness	1 ³ / ₄ " (44 mm)
Handing	Handed to order, not field reversible

Trim

Levers	Forged brass or bronze and cast stainless steel
Roses/ escutcheons	L full face and concealed: cold-forged brass or bronze and stainless steel N full face: heavy wrought reinforced brass or bronze and stainless steel Roses A, B, C: wrought brass or bronze and stainless steel; Roses AVA and MER: forged brass
Combinations	Available with levers only. Interior and exterior lever designs can be different. Roses cannot be combined with escutcheons.

Latch

Backset	2 ³ / ₄ " (70 mm) only
Armor	Standard: 1 ¹ / ₄ " x 8" x ⁷ / ₃₂ " (32 mm x 203 mm x 6 mm) Optional: 1 ¹ / ₁₆ " x 8" x ⁷ / ₃₂ " (27 mm x 203 mm x 6 mm)
Latches	³ / ₄ " (19 mm) throw stainless steel latches; top and bottom latches via concealed vertical rod
Strike	Standard: ANSI curved lip strike 1 ¹ / ₄ " x 4 ⁷ / ₈ " (32 mm x 124 mm) x 1 ³ / ₁₆ " (30 mm) lip to center with dust box Optional: Extended lip strike options (⁷ / ₈ ", 1", 1 ¹ / ₂ ", 1 ³ / ₄ ", 2")

Keying

Cylinder format	6-pin Conventional cylinder in full face mortise housing (standard); also available in concealed mortise housing, FSIC, SFIC and 7-pin SL cylinder formats plus less cylinder options.
Keyway	Patented Everest 29 S123 (standard); also available in open, restricted, and Primus XP security levels with available master keying and construction keying.

Warranty

	3 year limited mechanical
--	---------------------------



Specifications

Certifications

ANSI/BHMA	ANSI/BHMA A156.37-2014, Grade 1 operation and security; with FSIC Grade 2 security; with SFIC Grade 3 security
-----------	--

UL/cUL	UL 10C and CAN/ULC-S104 3-hour Fire Listed
--------	--

When furnished with the door trim and strike plate, LM9300 is intended for use on single swing doors or on the active leaf of pair doors rated up to 3 hours, with individual door leaves measuring up to and including 4' x 8'

UL 437 listed when using Primus XP UL 437 cylinder

CA Fire Code	All levers with a return to door of 1/2" (64 mm) or less comply
--------------	---

FL Building Code	Florida Building Commission Listings
------------------	--------------------------------------

Tornado	Tornado Assembly Approvals: With Intertek Testing
---------	---

UL approved to FEMA 361 and FEMA 320 and ICC 500 tornado shelter guidelines when paired with Steelcraft Paladin doors and frames

Federal	BAA compliant
---------	---------------
